

UTHERM Flat Roof PIR L

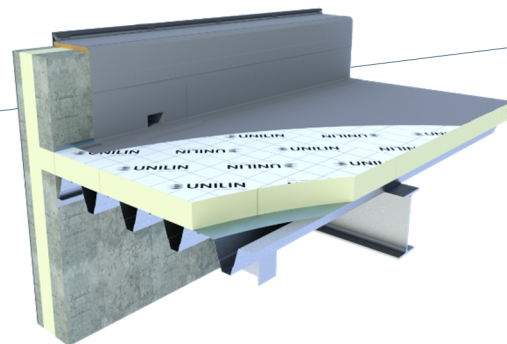

UTHERM Flat Roof PIR L is a high performance rigid PIR insulation board faced, both sides, with a gastight multilayer aluminium complex.

Technical Data Sheet

Facing	L: gastight multilayer aluminium complex
Insulation core	PIR (polyisocyanurate)
Finishing	Straight on 4 sides L-shape
Dimensions	1200 mm x 600 mm 2500 mm x 1200 mm (L-shape)
Thermal conductivity : λ_D according to EN13165: 2015	0,022 W/mK
Compression strength at 10% deformation: CS(10/Y)150 according to EN826	≥ 150 kPa (1,5 kg/cm ²)
Tensile strength perpendicular to faces	TR80 ≥ 80 kPa
Dimensional stability 48h, 70°C, 90%RH 48h, -20°C	DS(70,90)3: $\Delta e_{l,b} \leq 2$ / $\Delta e_d \leq 6$ DS(-20,-)1: $\Delta e_{l,b} \leq 1$ / $\Delta e_d \leq 2$
Deformation under pressure and temperature	DLT(2) $\leq 5\%$
Density PIR foam	32kg/m ³ \pm 3kg/m ³
Vapour diffusion resistance factor PIR foam (μ)	50-100
Reaction to fire according to EN13501-1	F B-s2-d0 (end use steeldeck)
Long term water absorption according to EN13165	WL(T)2 <2%

Product range

Thickness [mm]	R _D -value [m ² K/W]
30	1,35
40	1,80
50	2,25
60	2,70
80	3,60
90	4,05
100	4,50
110	5,00
120	5,45
140	6,35
160	7,25

Tapered

Dimensions	1200 mm x 1200 mm
Thickness	30 mm – 130 mm by 20 mm or by 25 mm 30 mm – 120 mm by 10 mm or by 15 mm

Some thicknesses may be subject to minimum order quantities. Please contact UNILIN division insulation for more information about availability.

UTHERM Flat Roof PIR L insulation boards comes with an environmental product declaration (EPD) and a CE-mark.

